

# SH3611 三节滚珠滑轨

## Full Extension Ball Bearing Slide



- 全拉出轻型钢珠滑轨
- 滑轨宽度: 36mm
- 载重: 20kg
- 表面处理: 电泳、电镀
- 材质: 冷轧钢板
- 材料厚度(内、中、外)轨: 1.0x1.0x1.0mm
- Full-extension
- Slide width: 36mm
- Dynamic load capacity: 20kg
- Finish: electrophoresis, plating
- Material: cold rolled steel
- Thickness of material(I/M/O)part: 1.0x1.0x1.0mm

### 滑轨安装尺寸 Installation size

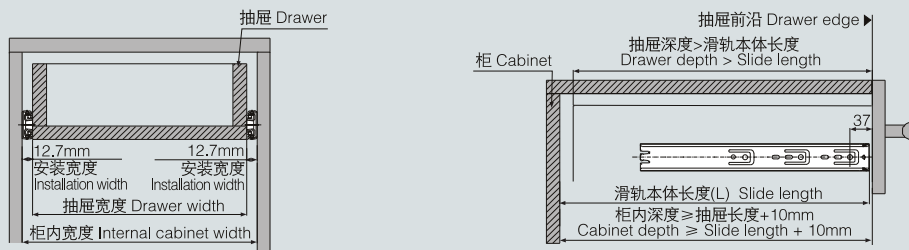

### 滑轨截面图 Profile

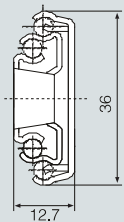

### 滑轨安装孔尺寸 Hole pattern

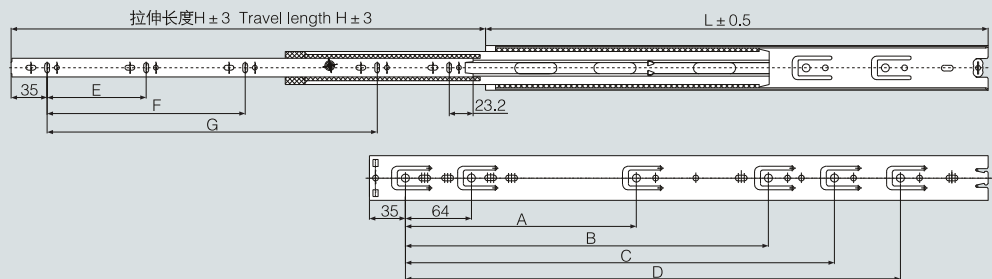

产品型号 Item No.	Length mm	A mm	B mm	C mm	D mm	E mm	F mm	G mm	L mm	H mm
SH3611-250	250	150				64			250	254
SH3611-300	300	200				128			300	304
SH3611-350	350	224				128			350	354
SH3611-400	400	224	288			128			400	404
SH3611-450	450	224	352			128	320		450	454
SH3611-500	500	224	352	416		128	192	352	500	504
SH3611-550	550	224	352	416		128	192	384	550	554
SH3611-600	600	224	352	416	480	128	192	416	600	604

滚珠滑轨

Ball bearing slide